

All dimensions to be checked on site. Figured dimensions take preference over scaled dimensions. Any errors or discrepancies to be reported to the Architects. This drawing may not be edited or modified by the recipient.

Copyright and ownership of this drawing is vested in RKD Architects, whose prior written consent is required for its use, reproduction or for publication to any third party. All rights reserved by the law of copyright and by international copyright conventions are reserved to RKD Architects and may be protected by court proceedings for damages and/or injunctions and costs.

RKD Architects' Quality Management Systems are certified to ISO 9001:2015.

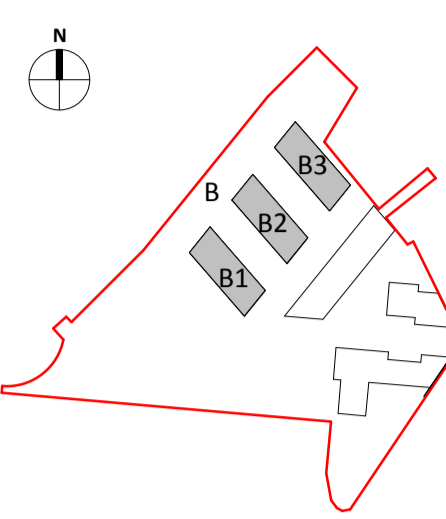

Notes:

- Site Boundary
- All levels shown are to the Irish Transverse Mercator (ITM) and are displayed in meters (m). All levels shown relate to the Malin Head datum. All dimensions shown in millimeters (mm)
- Symbol indicates top of floor level and relates to Malin Head datum

USE	
[Light Blue Box]	STUDIO APARTMENT
[Medium Blue Box]	1 BED APARTMENT
[Dark Blue Box]	2 BED APARTMENT
[Blue Box]	3 BED APARTMENT
[Purple Box]	INTERNAL RESIDENTIAL AMENITIES
[Yellow Box]	RETAIL
[Green Box]	COMMUNITY
[Grey Box]	ANCILLARY USE

Rev.	Date	Issued for Planning Application Submission	Description
A	OCT 2019	Issued for Planning Application Submission	

STATUS	PLANNING
PROJECT	THE CONNOLLY QUARTER
PROJECT ADDRESS	Lands to the Rear of Connolly Station, Dublin 1
DWG TITLE	BLOCK B PLAN_LEVEL 04
DWG NO.	18135-RKD-B-04-DR-A-1104

REV.	PROJECT NO.	SCALE
A	18135	1 : 200

RKD

59 Northumberland Rd
Ballsbridge, Dublin 4
D04 W9P6, Ireland

+353 1 666 1006
info@rkd.ie
rkd.ie

ARROW

Name: Farinmaggade 13, st th
DK-1364 Copenhagen K
Denmark

+45 4236 2860
info@arrowarchitects.com
www.arrowarchitects.com



1 BLOCK B PLAN_LEVEL 04
1 : 200